

# Building Project Update

## January 2008

Looking at the **Estimated Timeline**, you can see that we are **on schedule** and midway through the design process for the new Worship Center. **Schematic design plans** are included in this month's report, which will give you a better understanding of the design work to date. Detailed construction drawings will follow in April.

**Anything change during schematic design?** Yes. During the schematic design phase we increased the overall size of the Worship Center by 745 square feet, changed the location of the lobby and placed all new facilities on two floors instead of three. So, for this phase of construction, we will be building **33,245** square feet of space on two floors—**Ground and First**. Design changes were made in order to better orient the lobby to the main parking area and to realize additional economies by increasing the size of the ground floor rather than build another floor.

*We Are Here!*

In the coming years, we can **expand** to a third floor as balcony and additional classroom space are needed.

**What about the budget?** The total estimated project budget for 33,245 square feet of new building space is from \$11.6 to \$12.8 million. This budget includes all design, demolition, construction, permit fees, escalation, contingency and special equipment costs such as a new organ, piano, A/V and lighting systems. To date we are **within the budget estimate at \$11.6 million**.

More information will be presented on the schematic design at the upcoming **Radical Connections Family Celebration on February 10th**.

### Worship Center Project Overview

#### **Ground Floor**—9,720 square feet

- 1 toddler and 2 nursery rooms with 62 person +/- capacity
- 3 multi-use classrooms with 200+/- person capacity
- Entry lobby, restrooms and elevator

#### **First Floor**—23,525 square feet

- Flat floor Sanctuary with 800+ seating capacity
- Lobby including fireplace, coffee station and conversational seating
- 2 multi-use classrooms with 140+ person capacity
- Cry, translation, A/V booth, support, mechanical and storage rooms, restrooms and elevator
- Plaza area (approximately 40x250 feet) between existing and new sanctuary with covered walkways, garden landscaping and outside seating

#### **Future Second Floor**—10,000 square feet

- Balcony with 300+ seating capacity
- 2 multi-use classrooms with 150+ person capacity
- Small lobby, restrooms and elevator

**Questions?** Please contact Dale Himes (503) 804-8911, Scott Moore (503) 643-6511 or any Staff or Elder Board member. Also, we encourage you to visit [www.radicalconnections.org](http://www.radicalconnections.org) for Monthly Project Updates and Weekly Prayer Reminders.

### Estimated Timeline

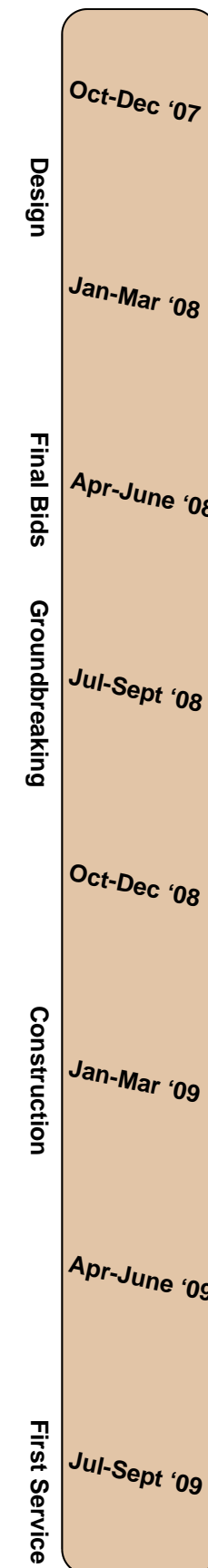

PARKING



GROUND FLOOR PLAN

MURRAY BLVD

PARKING

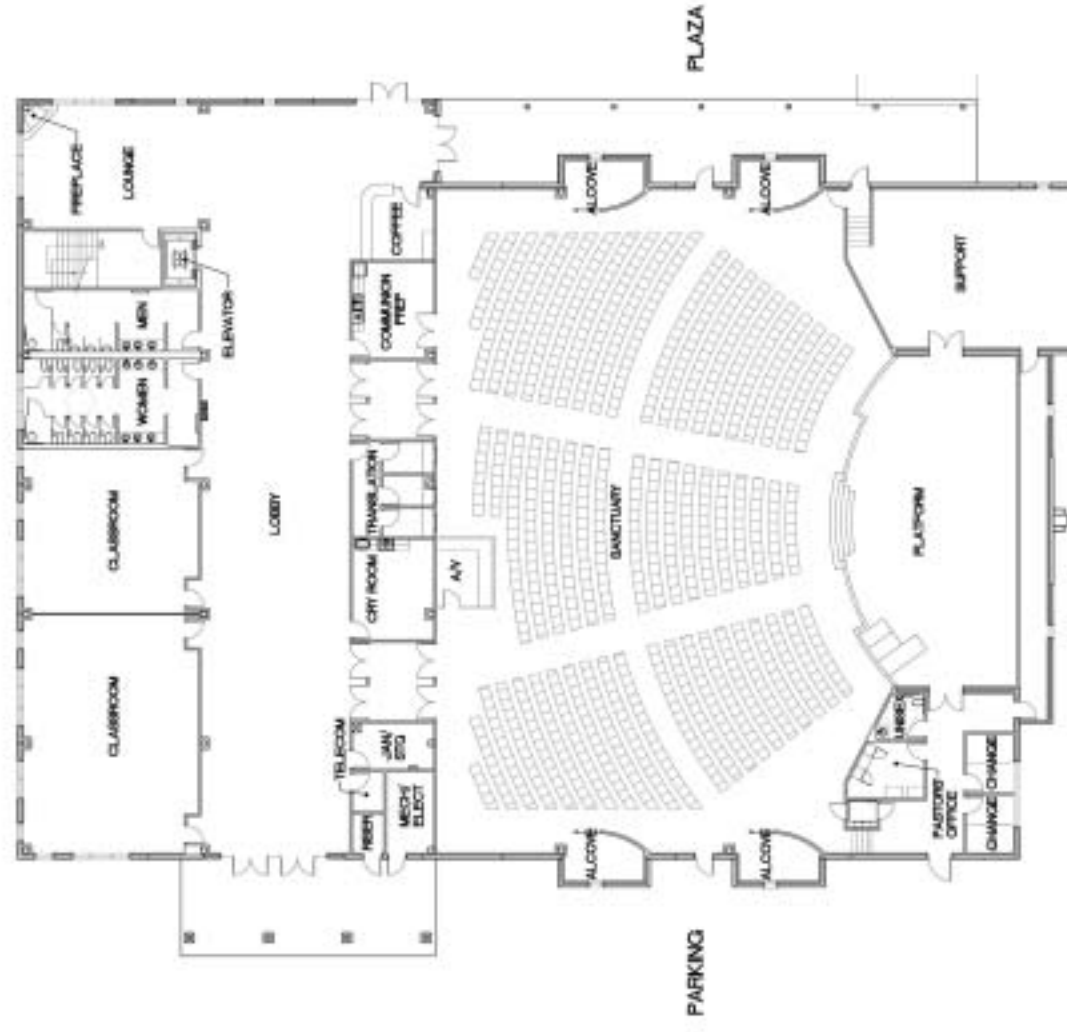

FIRST FLOOR PLAN

MURRAY BLVD

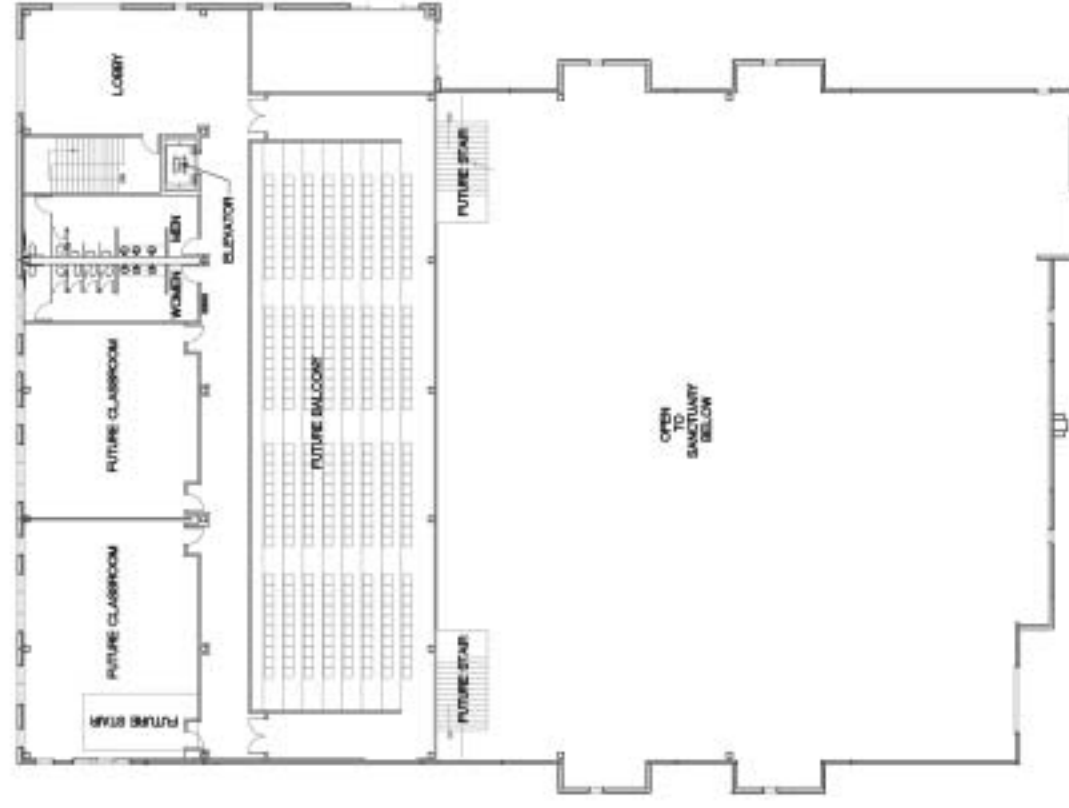

FUTURE SECOND FLOOR PLAN

MURRAY BLVD